

60MM DIAMETER European Fan Range

General Arrangement

Type 'E'

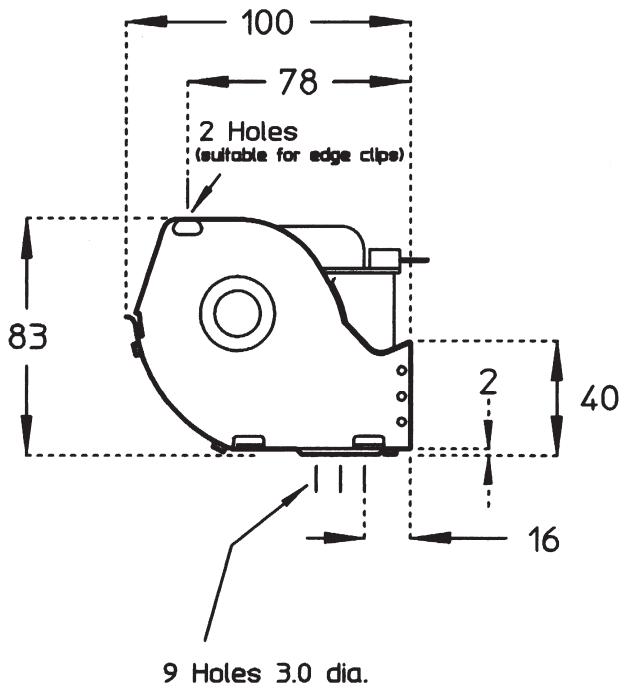

Element Mounting Detail

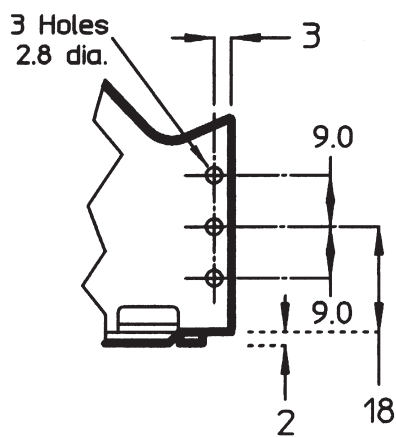

Drawn Left-Hand - 'EL'

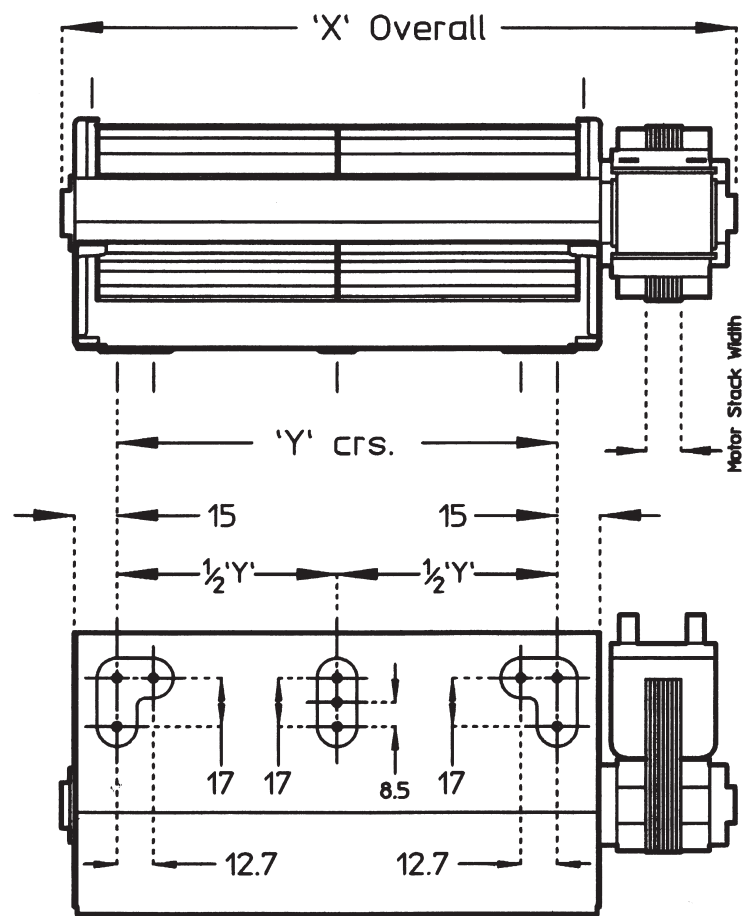

Drawn Centre Build - 'EC'

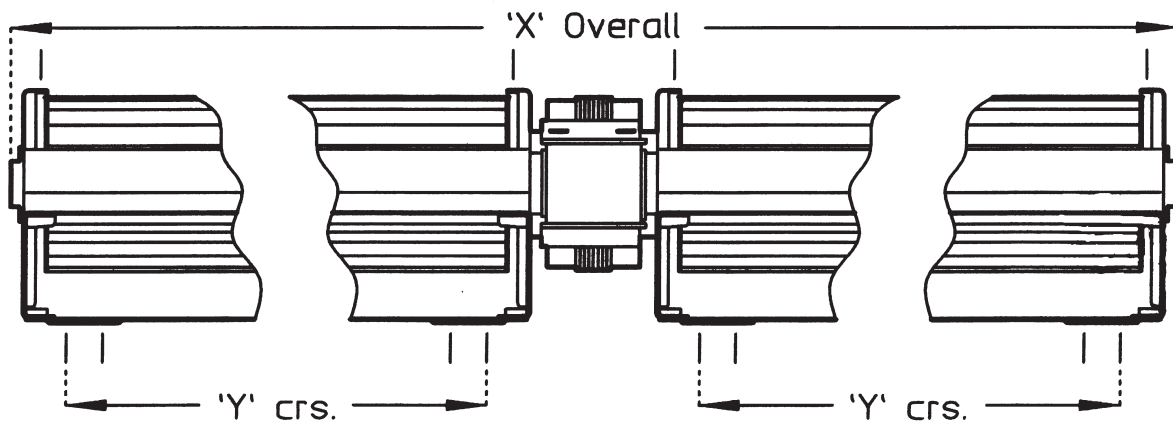

Table Range Code: E

Product Data Table

Style L,R or C (see GA)	Impeller Length (mm)	Motor Stack Width (mm)	Motor Code	Free Air Flow (L/S)	Max Static Pressure (mm H ₂ O)	Free Air Speed (rpm)	Overall Length 'X' ±0.5mm (see GA)	Fixing Centres Dimension 'Y' ± 0.5mm (see GA)
L,R	180	13.0	A	30	2.6	1280	235.0	152.0
		13.0	C	35	3.2	1500	235.0	152.0
		20.0	E	45	3.8	2050	242.0	152.0
		25.0	G	55	4.3	2450	247.0	152.0
L,R	240	13.0	C	39	1.8	1270	291.0	212.0
		20.0	E	53	2.3	1680	298.0	212.0
		25.0	G	66	3.8	2220	303.0	212.0
		38.0	J*	78	4.4	2500	316.0	212.0
L,R	300	13.0	C	41	1.5	1150	351.0	272.0
		20.0	E	58	1.8	1540	358.0	272.0
		25.0	G	71	3.0	1850	363.0	272.0
		38.0	J*	90	3.5	2400	376.0	272.0

NOTES:

Motor Code marked *requires cooling fan, add 15.9mm to dimension X.

Length 'X' is for standard motor bearings and standard impeller bearings

For sealed impeller bearings add:

15.0mm to Overall Length 'X' on styles L/R

30.0mm to Overall Length 'X' on style 'C'

Fan units can be supplied chassis mounted if required

When fitted with a heating element the Product Range Code changes to D.

A twist on/twist off motor mounting plate is available.