

# 60MM DIAMETER Heater Range

## General Arrangement

### High Pressure Type 'J'

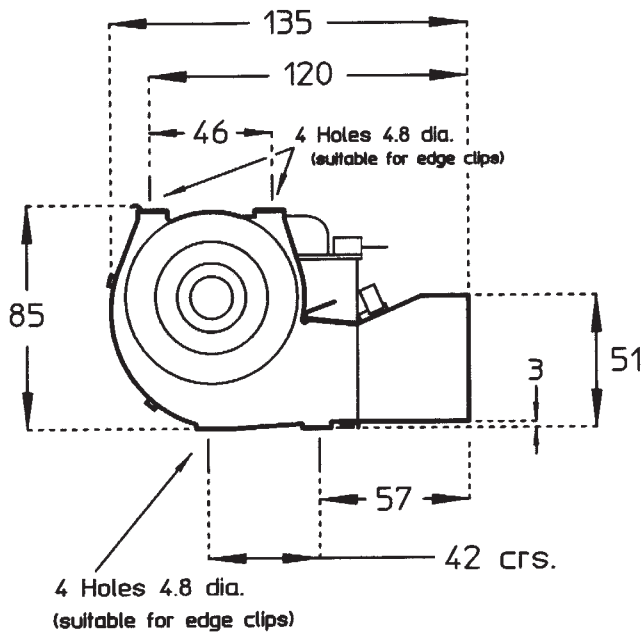

### Drawn Left-Hand - 'JL'

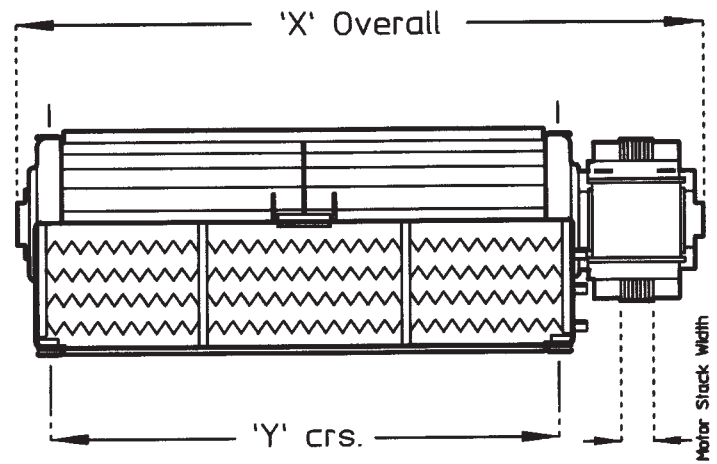

### Medium Pressure Type 'N'

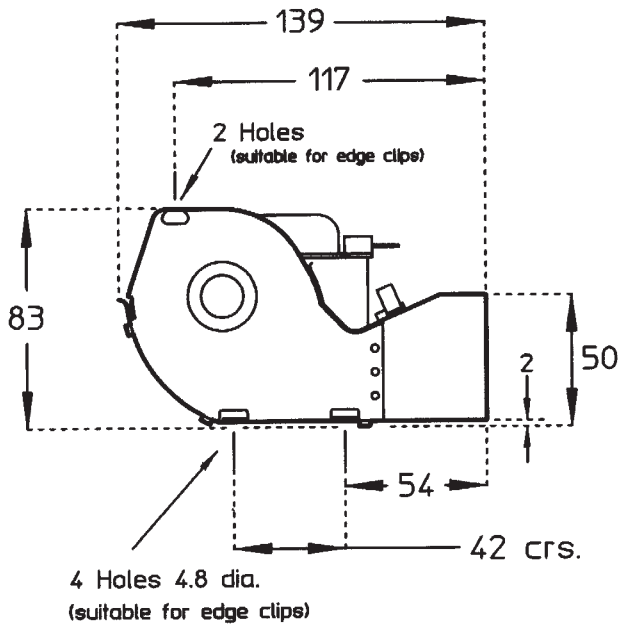

### Drawn Left-Hand - 'NL'

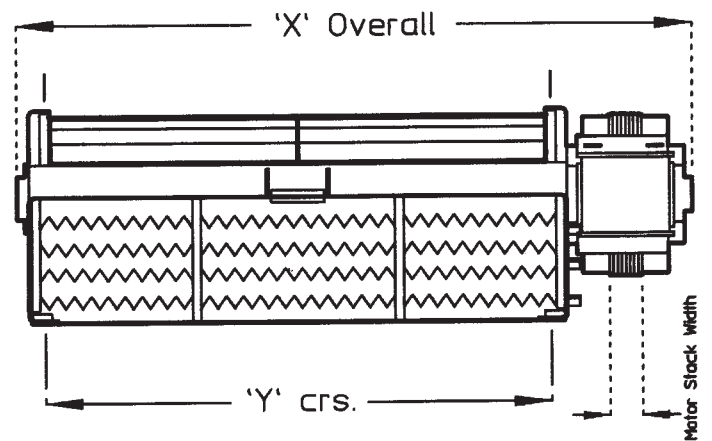

### Drawn Centre Build - 'JC' / 'NC'

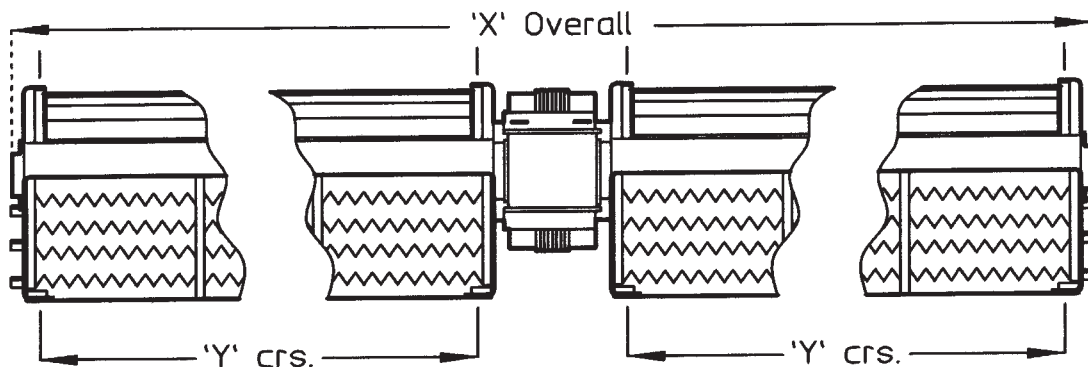

## Table Range Code: J & N

### Product Data Table

Style L,R or C See (GA)	Impeller Length (mm)	Motor Stack Width (mm)	Motor Code	Heat Output (kW)	Heating Element Tapping (kW)	Overall Length 'X' ±0.5mm	Fixing Centre Dimension 'Y' ± 0.5mm (see GA)	
							Medium Pressure (N)	High Pressure (J)
L,R	120	13 20	A E	1.5 2.0	0.75 + 0.75 1.00 + 1.00	193.0 200.0	131.0	131.0
L,R	180	13 13 13 20 25	A A C E G	1.5 2.0 3.0 3.0 3.0	0.75 + 0.75 1.00 + 1.00 1.50 + 1.50 1.00 + 2.00 1.0 + 1.0 + 1.0	254.0 254.0 254.0 261.0 266.0	192.0	192.0
L,R	240	13 20 25	C E G	2.0 3.0 3.0	1.00 + 1.00 1.00 + 2.00 1.50 + 1.50	315.0 322.0 327.0	253.0	253.0
L,R	300	13 20 20 25 38	C E E G J*	2.0 3.0 3.0 3.5 4.5	1.00 + 1.00 1.50 + 1.50 1.0 + 1.0 + 1.0 1.168 + 2.332 1.50 + 3.00	376.0 383.0 383.0 388.0 401.0	314.0	314.0
L,R	360	25 38	G J*	3.0 4.5	1.00 + 2.00 1.50 + 3.00	448.0 461.0	375.0	377.5
L,R	420	25 38	G J*	2.0 3.0	1.00 + 1.00 1.00 + 2.00	509.0 522.0	436.0	N/A
C	180/180	25 38	G J	2.0 (1.0 + 1.0) 3.0 (1.5 + 1.5)	0.50 + 0.50 0.75 + 0.75	474.0 487.0	192.0/192.0	192.0/192.0
C	240/240	25 38	G J	4.0 (2.0 + 2.0) 6.0 (3.0 + 3.0)	1.00 + 1.00 1.00 + 2.00	597.0 610.0	253.0/253.0	253.0/253.0
C	300/300	25 25 38	G G J	4.0 (2.0 + 2.0) 4.5 (2.25 + 2.25) 6.0 (3.0 + 3.0)	1.00 + 1.00 1.125 + 1.125 1.00 + 2.00	719.0 719.0 732.0	314.0/314.0	314.0/314.0

The above are examples only, outputs and tappings may be configured to suit your requirements

#### NOTES:

Motor Code marked \*requires cooling fan, add 15.9mm to dimension 'X'.

Air outlet performance has not been quoted since this will depend on the air discharge temperature which changes the specific gravity. This temperature will be very dependent on how the heater is installed in the unit and the unique system airflow characteristic that it develops.

Our standard thermal overload cut-out is rated at 80°C ±5°C. Other values can be supplied where required. If the airflow into the impeller is restricted, then red spotting of the element can occur, this effect is detrimental to the performance and life of the heater.