

60MM DIAMETER High Pressure Fan Range

General Arrangement

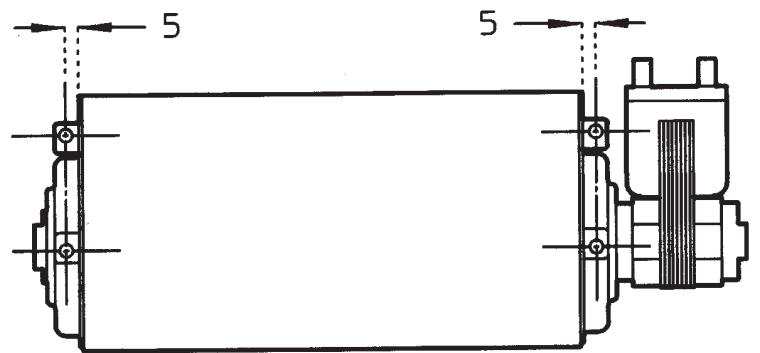

Drawn Centre Build - 'HC'

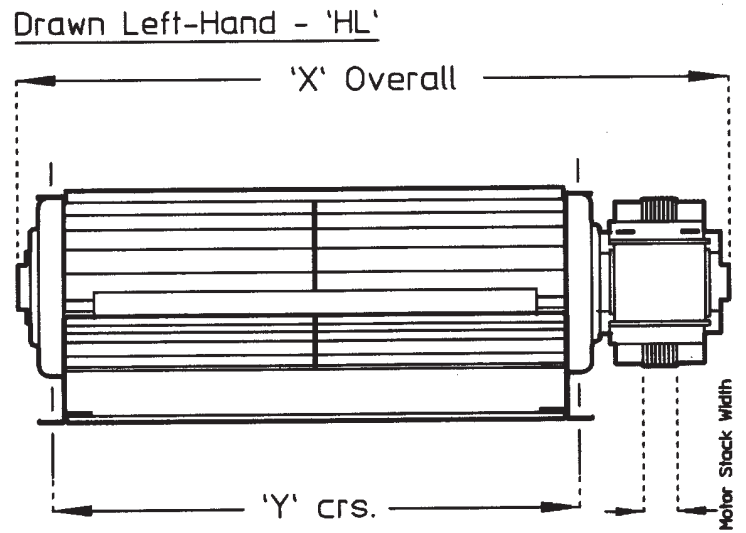
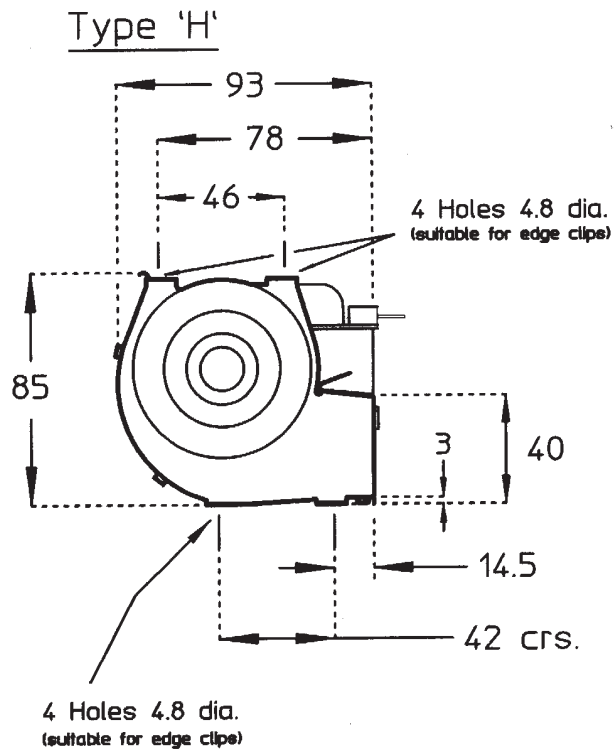
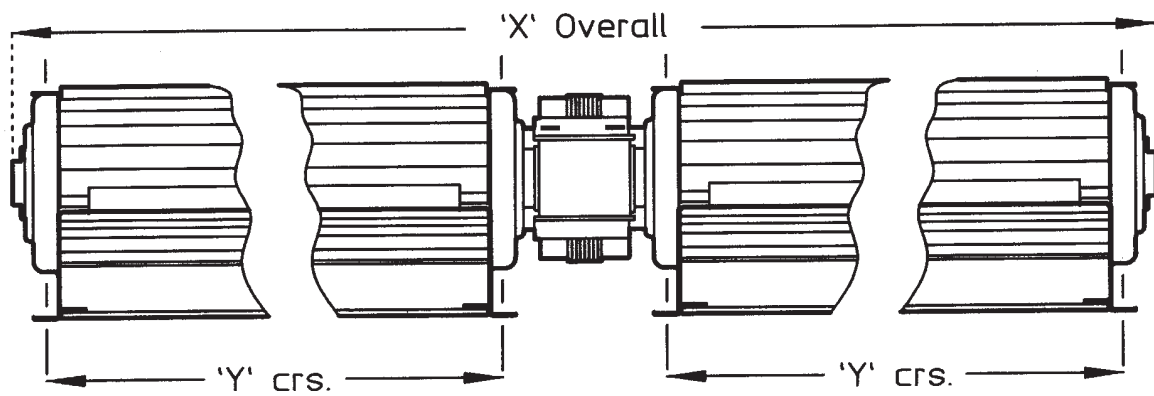

Table Range Code: H

Product Data Table

Style L,R or C (see GA)	Impeller Length (mm)	Motor Stack Width (mm)	Motor Code	Free Air Flow (L/S)	Max Static Pressure (mm H ₂ O)	Free Air Speed (rpm)	Overall Length 'X' ±0.5mm (see GA)	Fixing Centres Dimension 'Y' ± 0.5mm (see GA)
L,R	60	13.0	C	17	6.4	2500	131.2	70.0
L,R	120	13.0 20.0	C E	28 36	6.8 7.2	1620 2020	192.2 199.2	131.0
L,R	180	13.0 20.0 25.0	C E G	30 44 53	6.9 7.8 9.3	1120 1630 1900	253.2 260.2 265.2	192.0
L,R	240	20.0 25.0 38.0	E G J*	49 56 78	6.9 9.0 9.3	1360 1540 2040	321.2 326.2 339.2	253.0
L,R	300	20.0 25.0 38.0	E G J*	56 61 86	6.0 8.1 9.3	1250 1450 1900	382.2 387.2 400.2	314.0
L,R	360	25.0 38.0	G J*	64 87	6.7 7.5	1200 1620	451.2 464.2	377.5
C	180/180	25.0 38.0	G J	64 87	6.7 7.5	1200 1620	473.7 486.7	192.0/192.0
C	240/180	25.0 38.0	G J	68 88	6.3 8.8	1050 1380	534.7 547.7	253.0/192.0
C	240/240	25.0 38.0	G J	72 91	5.8 7.8	1010 1250	595.7 608.7	253.0/253.0
C	300/240	25.0 38.0	G J	76 98	4.7 7.6	980 1200	656.7 669.7	314.0/253.0
C	300/300	25.0 38.0	G J	84 102	5.8 6.5	900 1150	717.7 730.7	314.0/314.0
C	360/360	25.0 38.0	G J	87 104	6.0 6.5	850 940	844.7 857.7	377.5/377.5

NOTES:

Motor Code marked *requires cooling fan, add 15.9mm to dimension X.

Length 'X' is for standard motor bearings and standard impeller bearings

For sealed impeller bearings add:

15.0mm to Overall Length 'X' on styles L/R

30.0mm to Overall Length 'X' on style 'C'

Fan units can be supplied chassis mounted if required.

A twist on/twist off motor mounting plate is available.