

INSTALLATION, OPERATION AND MAINTENANCE INSTRUCTIONS FOR

WEATHERPROOF 1.5 kW QUARTZ-ZONE RADIANT HEATER

Catalogue Number QZWP15

PLEASE RETAIN THIS LEAFLET FOR FUTURE MAINTENANCE

1. GENERAL

Quartz heaters are high intensity radiant appliances, using tungsten-halogen lamps as the energy source. The lamps radiate their energy primarily in the short-wave infrared waveband with high energy conversion efficiency and good heat penetrating properties.

The heater is supplied complete with an angular fixing bracket. Its construction makes it suitable for all types of outdoor situations. An outline drawing of the units, together with their overall dimensions is shown in Figure 1.

2. SAFETY NOTES

- The heater should not be operated in ambient temperatures greater than 30°C (86°F), otherwise the life of the quartz unit could be shortened.
- The heater should not be operated in areas subject to excessive dust.
- The heaters must be mounted with the Quartz element in the horizontal position.
- This radiant heater is capable of projecting a significant amount of radiant energy for a considerable distance in front of the reflector. Great care should be taken with its mounting if there are flammable materials in the vicinity. This heater must not be used in areas subject to flammable vapours such as paint solvents or petrol fumes.
- Do not touch the heater with wet hands.
- When unplugging the heater from the socket, pull on the plug, not the cable or heater itself.
- Heater must be used with adult supervision.
- Avoid improper use of extension leads.
- Should the power lead become damaged do not use the appliance. Contact Consort Equipment Products Ltd regarding replacement of the lead.
- Disconnect the appliance from the power supply when not in use.

3. INSTALLATION

Prior to installation, remove packaging from around the unit **TAKING CARE NOT TO TOUCH THE ELEMENT WITH YOUR FINGERS..**

The minimum recommended mounting height is 1.8 metres.

NOTE: The heater must always be installed horizontally, using the mounting bracket provided. This ensures correct positioning and adequate clearance.

A minimum air gap of 400 mm should always be allowed between the top of the heater and the ceiling or roof.

A safety distance of 1 metre should always be left in front of the heater.

For wall mounting purposes, a bracket arrangement is supplied as standard and this is shown in Figure 2. It is essential that the radiant energy is directed away from the wall. For maximum heating effect the angle of the front face of the unit to the horizontal should be about 45°.

The appliance must not be located directly below a wall socket.

As well as an efficient conversion of electrical energy into radiant heat energy, the effectiveness of radiant heaters depends on efficient absorption of this energy by people. Heaters mounted overhead, with their beams directed straight down, will tend to warm only shoulders and tops of heads. More efficient absorption is obtained if the radiant heat is directed from one or both sides of the person. In any situation, the optimum angle for the heaters will be with the plane of the reflector at about 45° to the horizontal. Heating schemes should be designed such that the area to be heated is effectively covered by units which are mounted close to this angle.

Figure 1 – Outline Dimensions of Quartz Heater

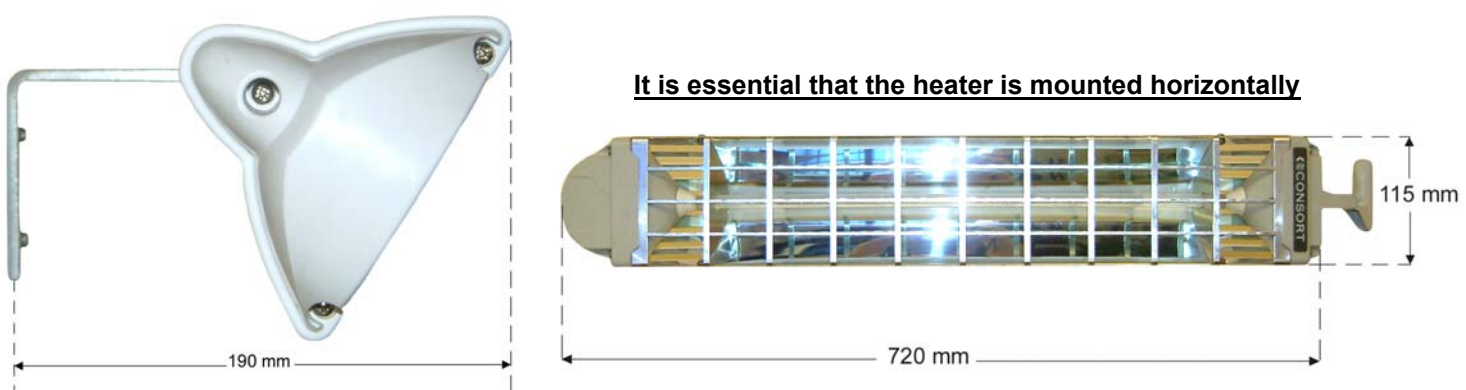

Do not use the heater directly near a bathtub, swimming pool or shower.

The heaters are fitted with safety guards. These are only intended to prevent large objects from hitting the emitters. On no account should the heater be operated with the guard removed.

Figure 2 – Wall Mounting of Quartz Heaters

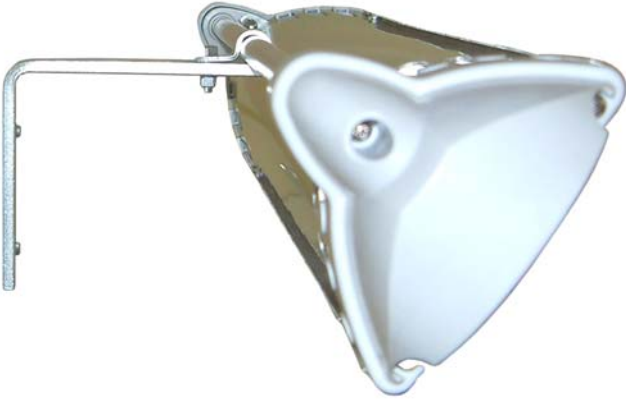

4. ASSEMBLY

Carefully unpack the heater. During heater assembly and installation DO NOT TOUCH the element, otherwise finger marks could lead to de-vitrification and cracking of the sleeve. Any finger marks should be carefully removed with methylated spirits (see also section 7 – 'Maintenance').

For all units, assemble the yoke onto the heater body, tightening the clamp bolts finger tight.

Secure the mounting bracket to the wall with suitable fixings. Ensure the position of this bracket will allow suitable clearances between the heater, when fitted, and adjacent walls.

Finally adjust the direction of the heater to irradiate the desired area and tighten up all clamping nuts and bolts.

5. ELECTRICAL CONNECTIONS

WARNING: Ensure that the electrical supply is isolated and made safe before making any electrical connections.

WARNING: The Quartz heater must be connected to a known good earth.

The heater is a Class I, IP65 rated product suitable for outdoor use. To maintain the protection rate of the appliance, it must be connected to the main power supply by means of a minimum IP65 system, as per the standard: IEC 60346-7-708 1988.

The installation should be carried out by a competent electrician and should comply with the requirements of the IEE Wiring Regulations, BS7671 latest issue, and be connected via a suitable isolating switch.

6. CONTROL

In control systems, heaters may be switched on and off, using suitable contactors, linked to time switches. Details of suitable circuits and advice on the correct siting may be obtained from Claudgen.

7. MAINTENANCE

WARNING: Before carrying out any maintenance, ensure that the mains supply is switched off and made safe. Also ensure that the unit has cooled and is not too hot to handle.

The reflector is very durable, nevertheless, it will become dirty after a period of time. To maintain the efficiency of the unit, the reflector should be cleaned regularly. Cleaning the reflector should require no more than a damp cloth. Avoid using any abrasive cleaners. If necessary, lamps may be cleaned using a clean cloth moistened with methylated spirits.

CAUTION: After cleaning, ensure that all solvents, such as methylated spirits, have evaporated and dispersed before the heater is switched on.

In the interest of progress the Company reserves the right to vary specification from time to time without notice. The material listed is offered subject to the Company's General Conditions of Sale, a copy of which may be obtained on request.